

The enclosed Bitmaps are for a plain simple gun cart. The idea is based on a plan from Popular Mechanics that made a workbench. The unit is assembled by slotting the pieces together like a puzzle. Once assembled it forms a strong one piece unit. Care must be taken to keep the slots tight and cut and layout should be checked carefully.

Requires one half sheet of ½ inch plywood split in long (8ft) direction. One sheet will make two carts. Design utilizes ten inch wheels that are common at most local lumber yards. Larger tires or other changes can be made easily. Cost should be around \$20 up or down depending on quality of lumber used. ¾ inch can be substituted by widening slot towards inside of cart.

Lots of flat space for painting scenes or adding names etc.

When broke down whole unit lays flat in car or truck. Completely portable carried my five-foot workbench back and forth to college many times with no difficulty.

Have fun with it and let me know how it works out for you.

See you on the Trail Russ N. Hound aka Doug Curtis

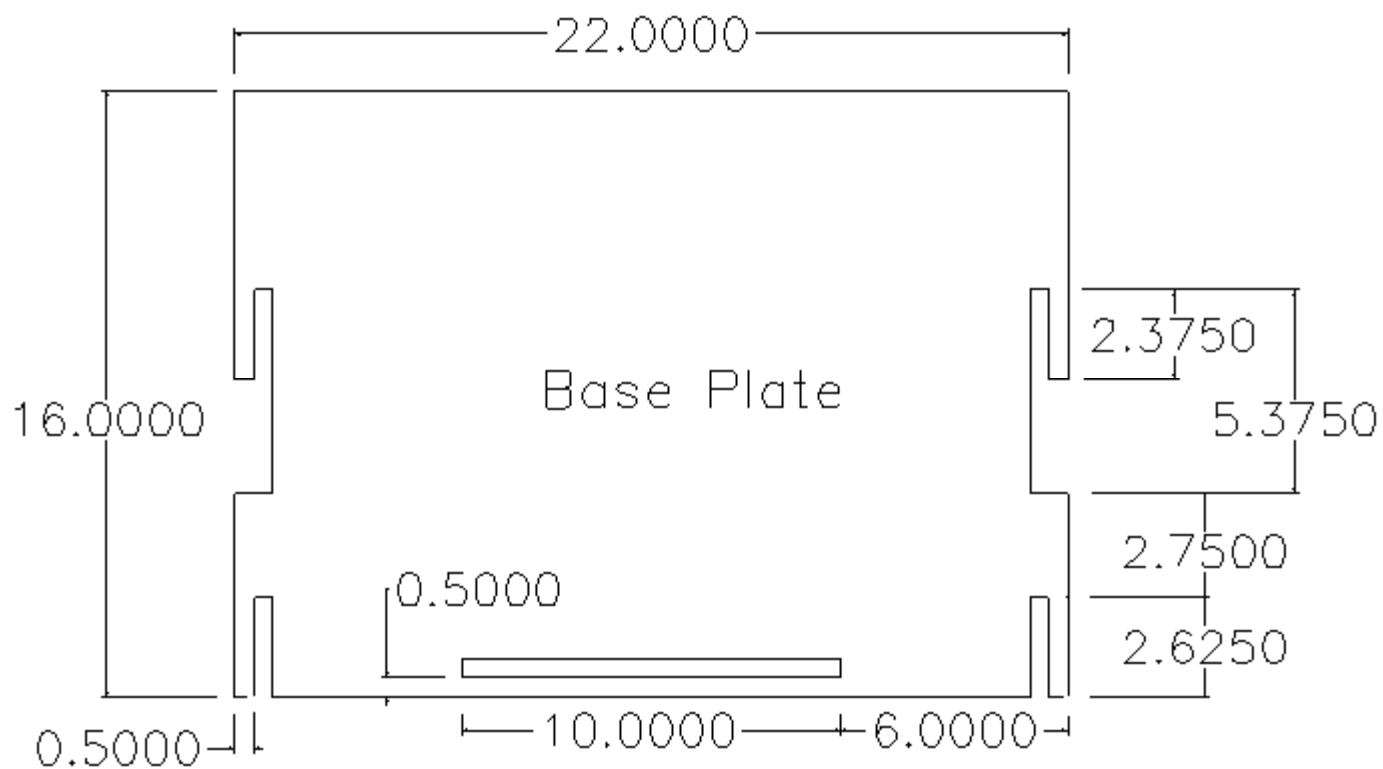

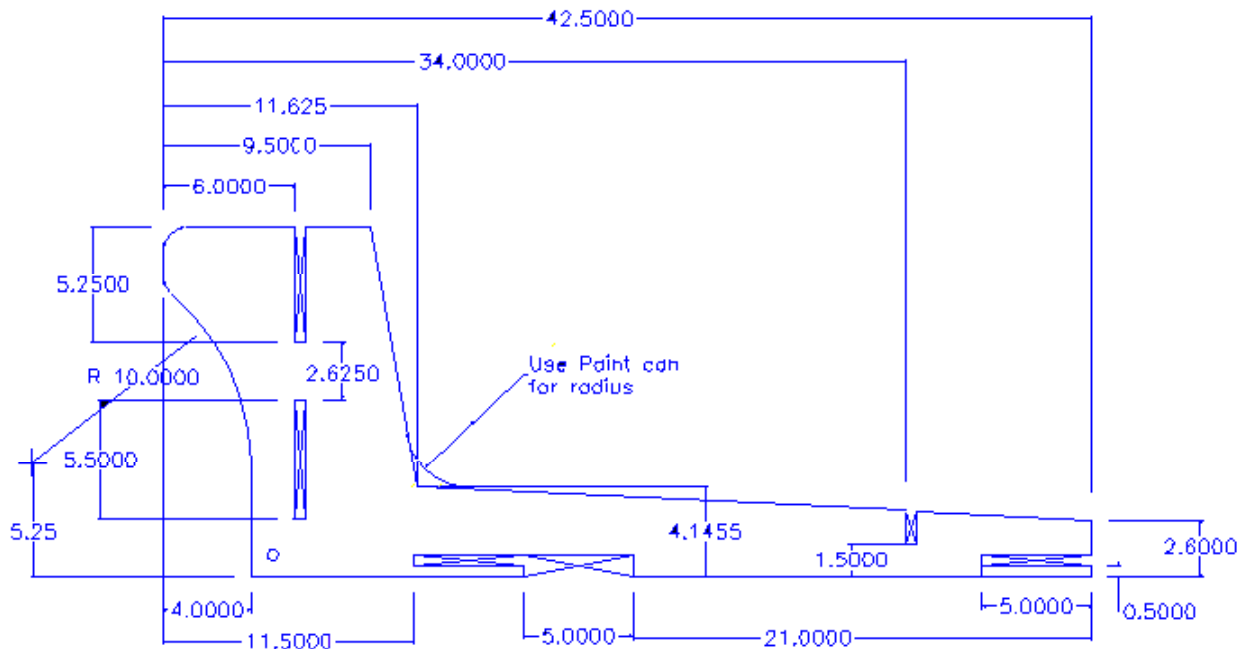

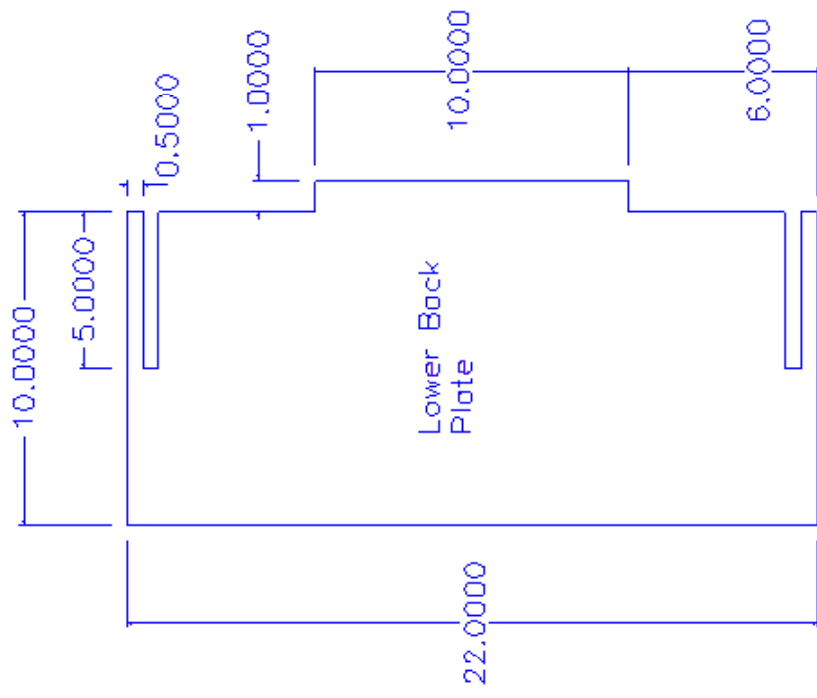

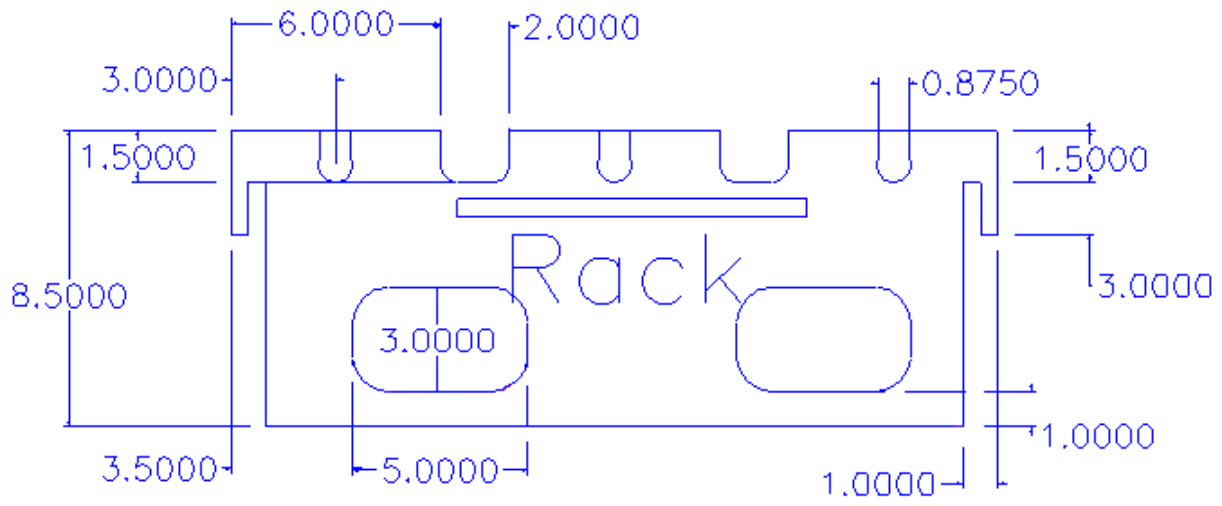

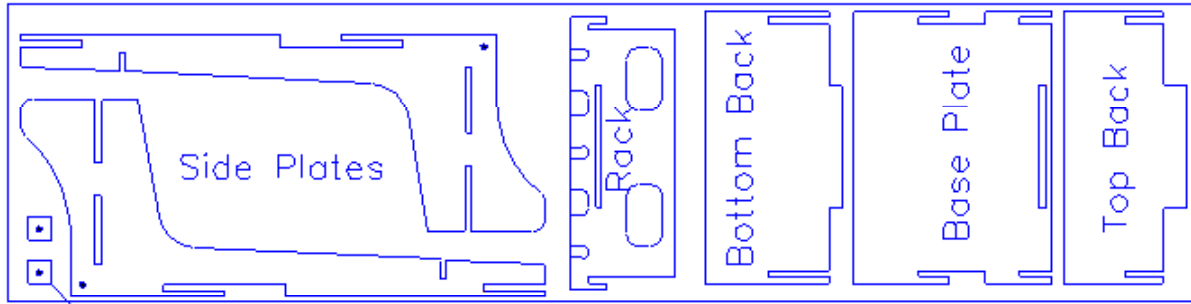

Extra Bracing for axles

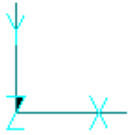

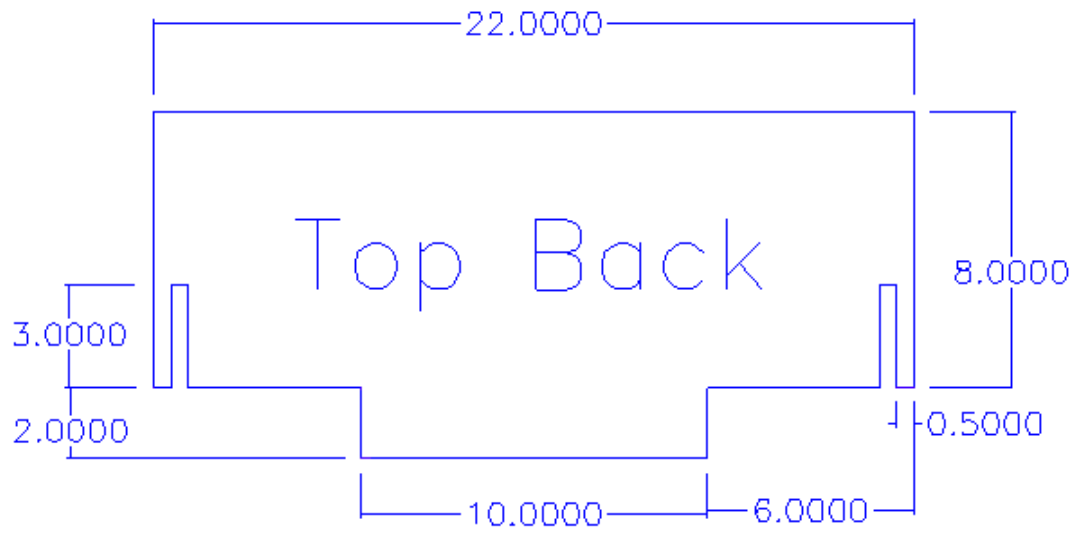

Wheel Plates

